

Hessaire Pump Replacement Instructions

Covers Most Models



⚠ WARNING Always unplug unit from power source before performing any maintenance. Failure to do so could result in serious injury, electrical shock or death. Ensure back access panel and all parts are securely fastened back in place and nothing is obstructing the fan blade prior to powering the unit up again. See warning label on back of cooler prior to servicing.



Suggested Tools:
#2 phillips screwdriver, flathead screwdriver

Picture instructions below show MC37/M150. See "special notes" for tips on replacing pumps in other models.

- 1) Ensure unit is turned **off** and **unplugged**.
- 2) Remove back panel from your cooler by removing the 2 phillips screws from the upper back side of the cooler. Push panel up and pull out bottom.
- 3) Pull out back section of media pad. It is recommended to remove media pad on pump side of cooler to access pump cord and green water hose harnesses that run down corner of cooler to the pump. Locate control panel.
- 4) Remove control panel with a small/medium flathead screwdriver to pry panel up at top slots. Locate "quick disconnect". Depress tab of disconnect and pull connector apart. *Note: take pic of wire locations for easy installation of replacement pump.* Once disconnected, feed end down through opening in control panel box. For models MC18/MC26/MC92, pump "quick connect" is located by removing cover from back of control box—inside the cooler.
- 5) Once pump power cord and water hose is free all the way to the pump, disconnect green water hose from top of pump by removing the 2 phillips hold down screws and turning the pump itself to unscrew the barb fitting/green hose.
- 6) To install replacement pump, simply reverse steps shown above. Thread hose & barb fitting into replacement pump.

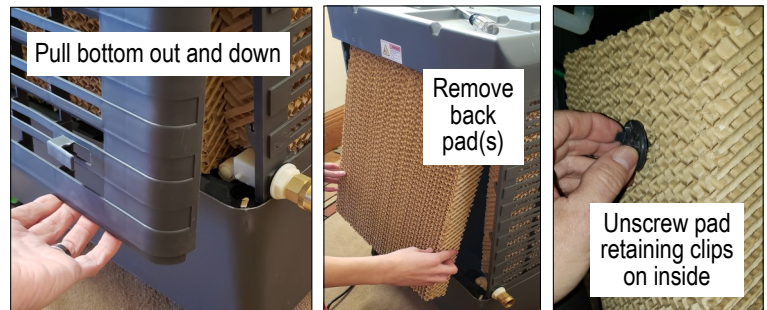
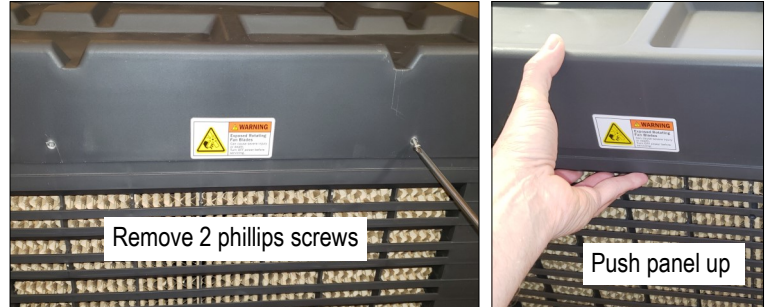

Special Notes:

MC61/M250, MC92/M350: Side media pad is removed by taking plastic side panel off which is held in place with a phillips screw.

MC92/M350: Pump "quick connect" is accessed through the back of the cooler by removing "snap-on" rear control box cover.

MC18: Pump is disconnected by removing the 2 phillips screws and control box cover on the inside back upper left corner. Unplug "quick connect".

MC26: Pump is disconnected by removing the back control panel box cover from inside the back of the cooler. Once removed, unplug the pump plug pigtail from the back of the electronic control board.

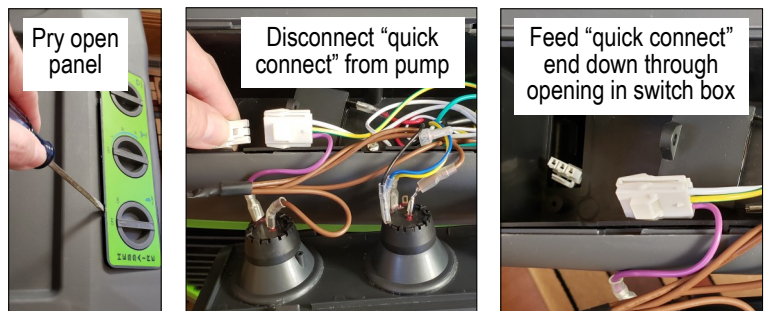

⚠ Ensure the following when installing the replacement pump prior to powering unit up:

- Unit is unplugged.
- Pump hold down screws are firmly in place.
- Green water hose is firmly connected.
- Pump cord & water hose are secured to corner of cooler and out of the path of the prop.
- Pump "quick connect" is fed up into control box and securely connected.
- Side media pad is fastened back in place.
- Control panel is firmly "snapped" back in place.
- Back media pad is set back in place and back access panel is securely held in with 2 screws.

